

G5 Aqua Star >>>

Coral reef / Marine fish



Timer



Night Mood



Dimmer

User's Manual

Specification

Item	Specification	Item	Specification
LED Brand	Epistar	Input Voltage	100-240V AC
LED Quantity	24pcs	Single LED power	3W/5W
Max power	95W (±5%)	Product/Lamp size(mm)	220*40*120mm
Net weight	2.00kg	Package size(mm)	390*258*78mm
Shell material	Aluminum +Plastic	Shell color	Black
Working temperature	-10°C-50°C	Storage temperature	-20°C-70°C

LED Layout

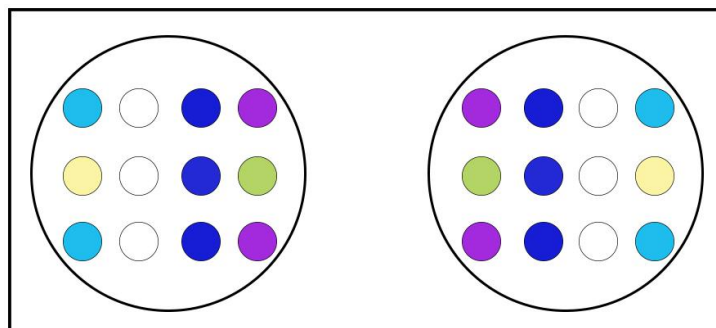

LED Channel	Color of the LED chips
Channel A	 14000K Cold White
Channel B	 450nm Deep Sea blue+457nm Dark Blue
Channel C	 430nm Indigo blue
Channel D	 420nm Purple
Channel E	 3000K Warm White
Channel F	 500nm Green

Spectrum

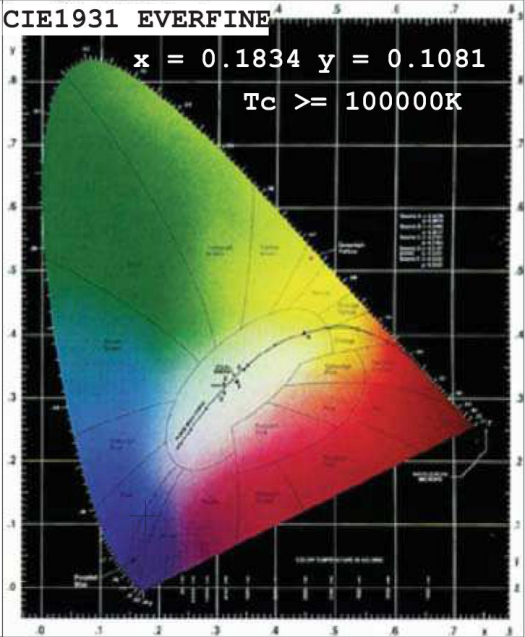
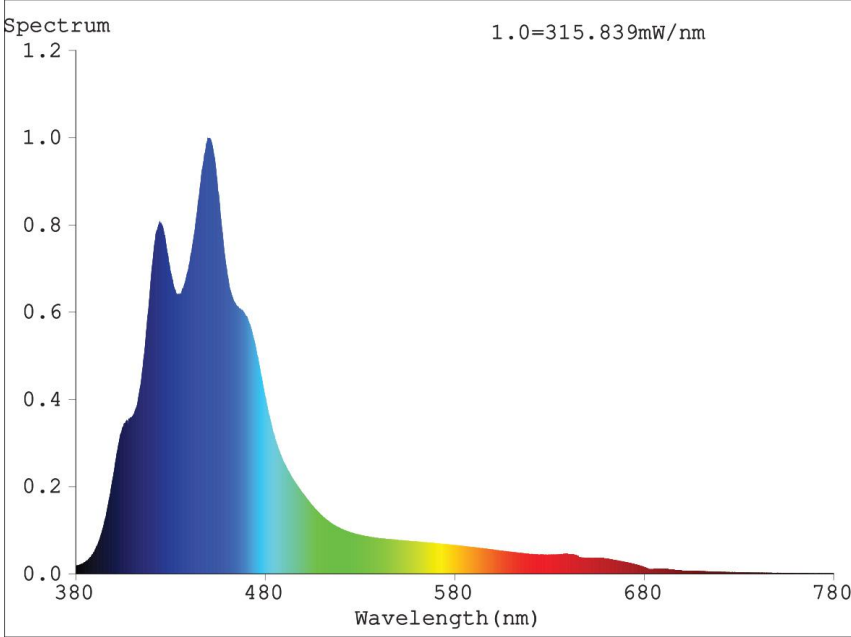

Operation Manual

1. Action Button display

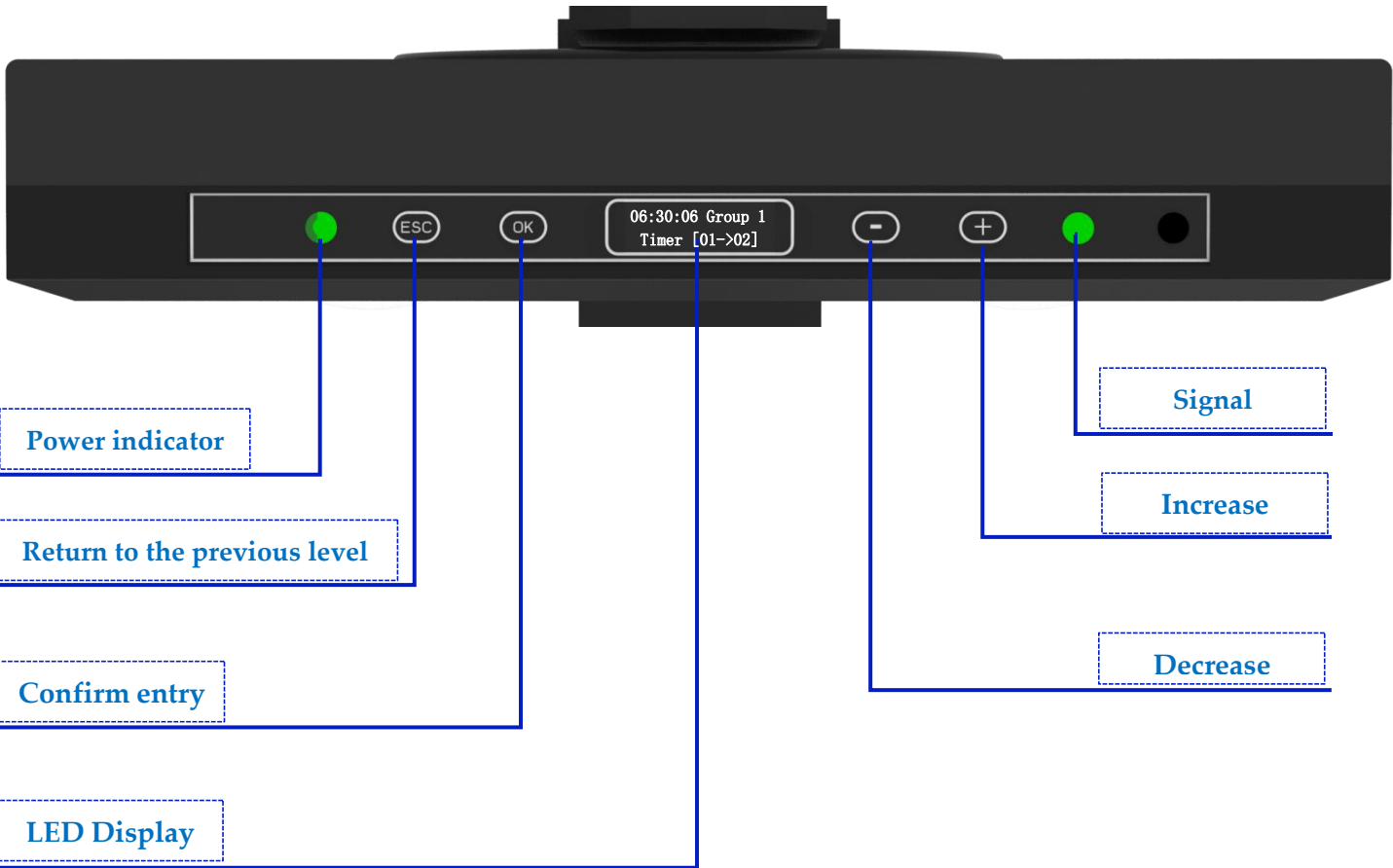

2. Introduction to menu interface functions

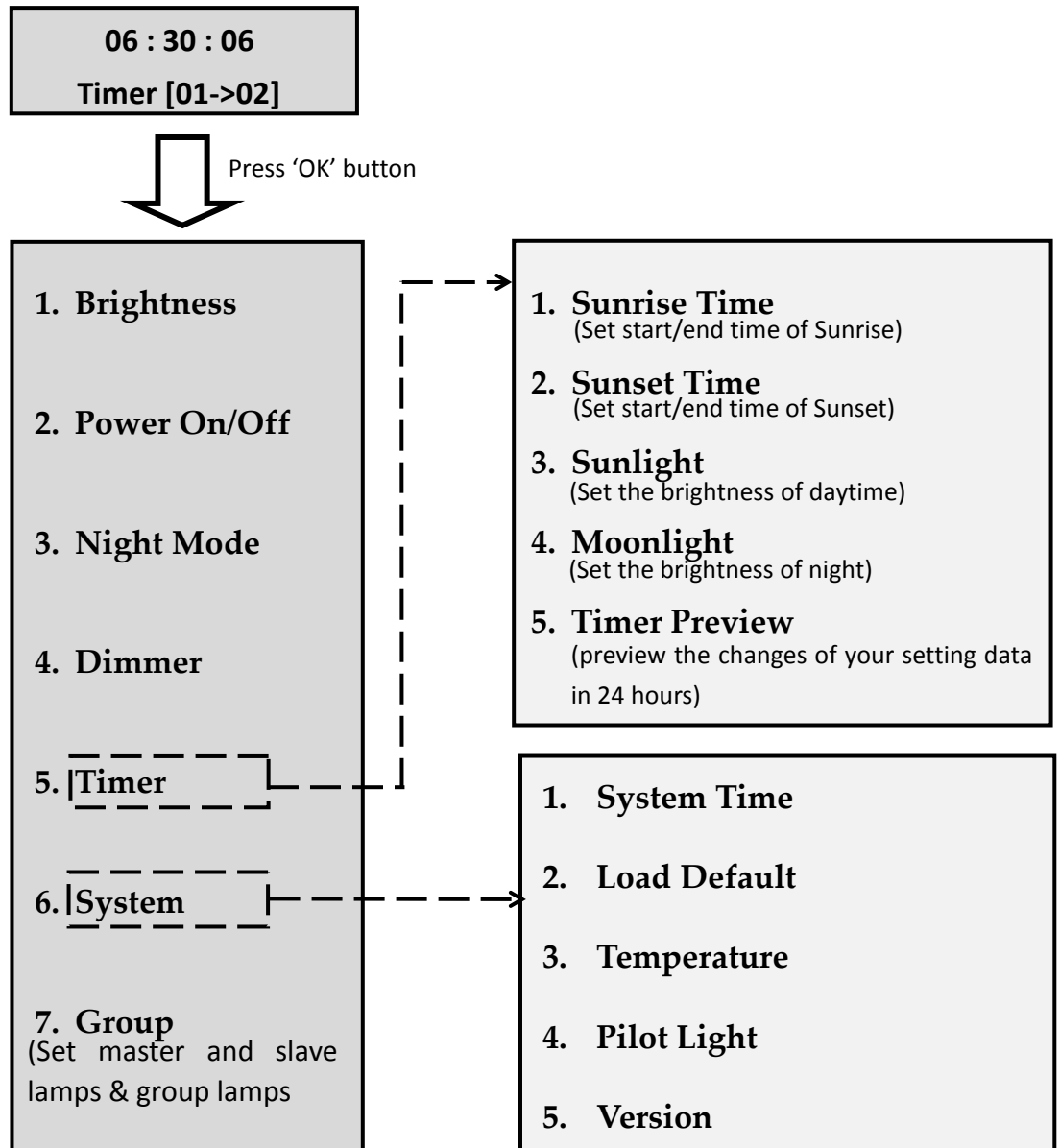

3. The meaning of the functions of the menu

- **Introduction of main interface**

First line shows the current time of device.

Second line shows the operation mode, numbers in parentheses represents the current working stage.

For example, Timer [01->02] , the light runs in timer mode, and working from the first time point to the second time point.

- **Introduction of each mode**

1. Brightness

Displays the current brightness (as a percentage) of each channel.

2. Power On/Off

Write off the light without turning off the power supply.

When select power“off”, the lights go out.

When select power“on”, the timing mode will resume normal operation.

3. Night Mode

When "On" is selected, the light blue channel opens the brightness of 10%.

If you want to return to the timer mode, select the "off".

4. Dimmer

Dimmer is instant mode, set up each channel's data and run it all day.

If you want to return to the timer mode, press “ESC” button.



Please note that, the light will run “Timer” mode if we press “ESC” button. Please DO NOT press “ESC” button after set date of “Dimmer” mode if you want the light run “Dimmer” mode!

5. Timer

> 1. Sunrise time

Set the start and end time of sunrise (time point 01 &02)

> 2. Sunset time

Set the start and end time of sunset (time point 02 &03)

> 3. Sunlight

Set the brightness of light from time point 02 to time point 03

> 4. Moonlight

Set the brightness of light from time point 04 to time point 01

> 5. Time Preview

Before applying this pattern, you need to set the sunrise and sunset data you want.

In parameter preview mode, you can preview the changes of your setting data in 24 hours.

Please note that this is a quick preview mode, that is, the lamp will quickly show the light intensity of each time period in a few minutes.

The graph below shows the light curve over a 24 hour period:

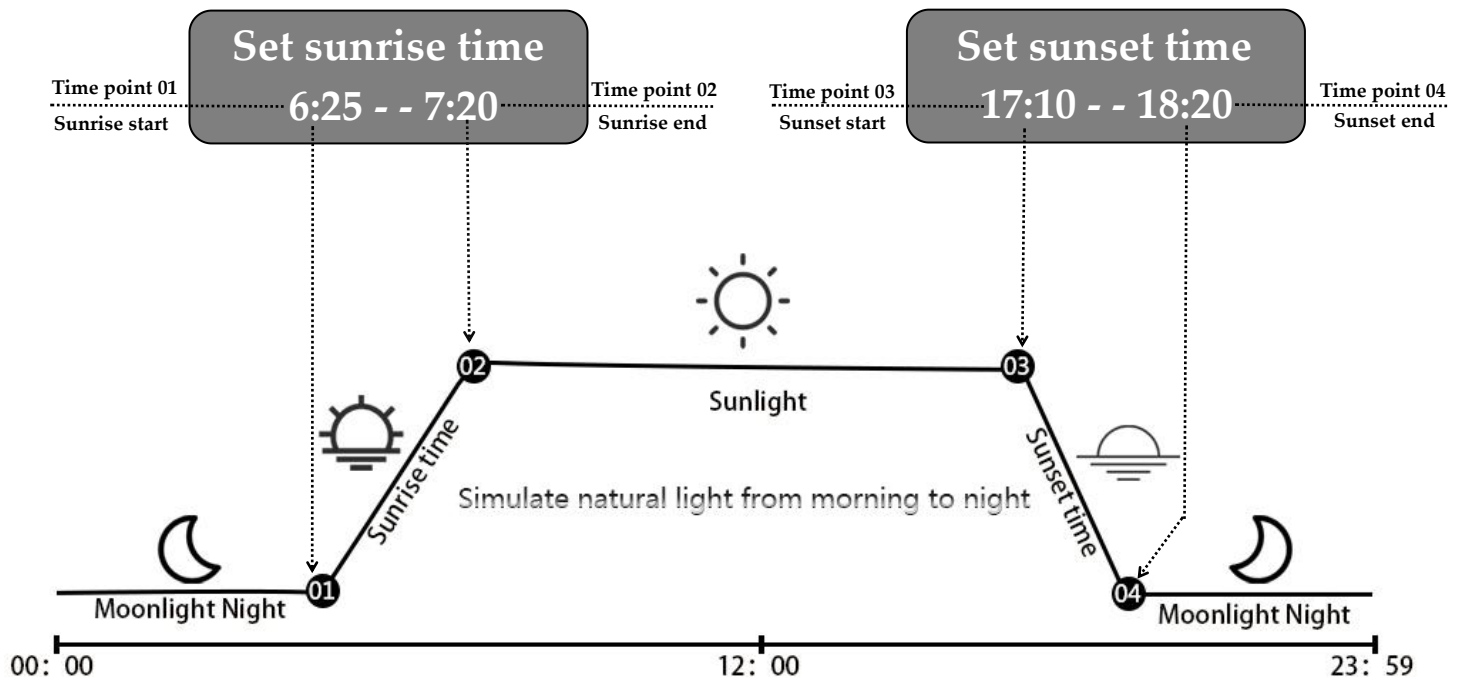

6. System

> 1. System Time

Set your local time (system time shown in main interface) , the light will run according to the system time you set.

> 2. Load Default

Clear system parameters, restore the factory default Settings.

> 3. Temperature

Shows the current time, the internal temperature of the lamp, and the speed of the fan.

> 4. Pilot Light

Indicates whether the control card is working properly

> 5. Version

Version of the light.

7. Group

Set master and slave lamps & group lamps.

1. Master slave lamp setup

Master : Main light, you can set all the parameters. From the lamp to keep in line with it.

Slaver : From the lamp, set to from the lamp, this lamp will not be dimmed. Main Lamp brightness/parameters can only be synchronized within the same group.

2. Grouping

The master and slave lights must be in the same group, so can be synchronized.

Maximum number of groups: 10

4. Remote Control

G5 aquarium light support remote control too. Picture and function of each button as below,



Installation

➤ Packing list

1. G5 LED aquarium light * 1 pcs
2. Full Aluminum bracket * 1 set
(Extension bar of the bracket included)
3. Screws for bracket * 1 set
4. Adapter * 1 set
5. Remote controller * 1
6. Power cord *1

➤ Mounting method of bracket

Recommended fish tank size : 18-35 inch long fish tank

Screws and tools:

Screw ❶ * 2pcs

Screw caps for screw ❶ * 2pcs

Screw ❷ * 2pcs

Screw caps for screw ❷ * 2pcs

Screw ❸ * 2pcs

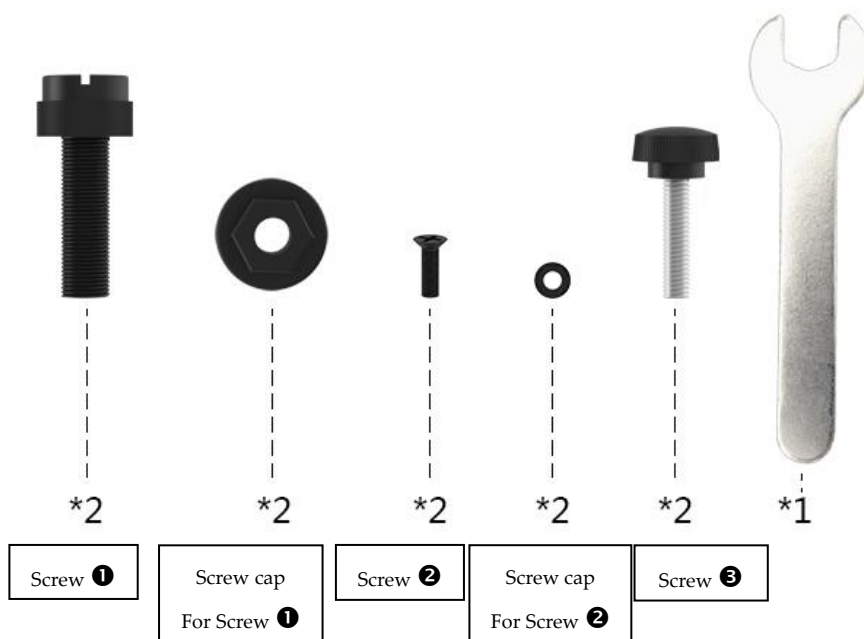

Assembly drawing :

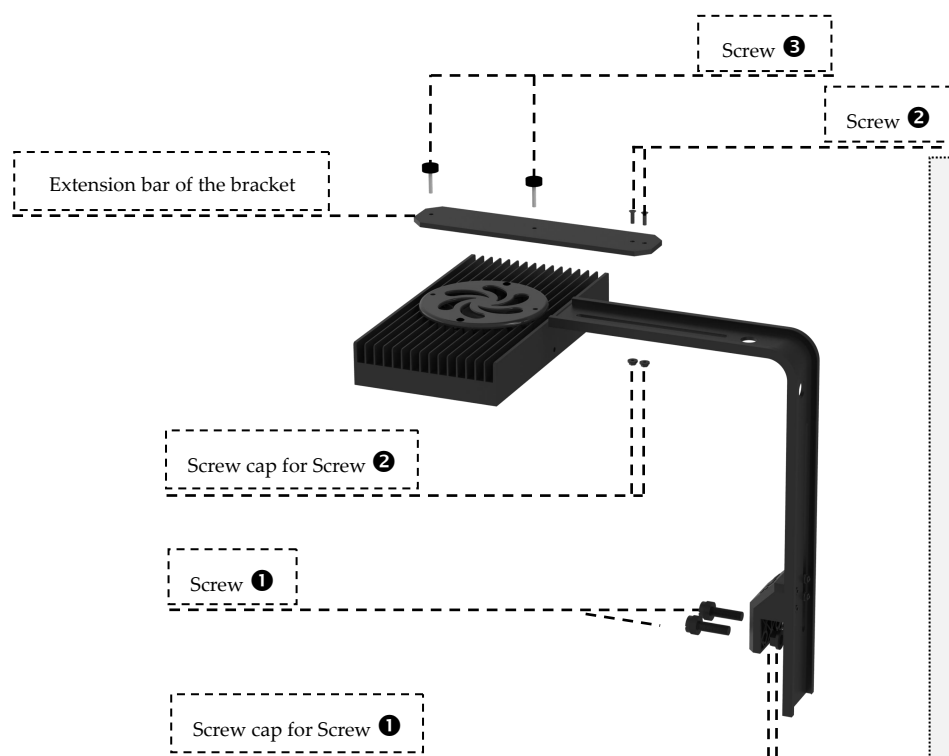

Warm tips:

(1) 'Screw caps for screw ❶' is designed as a spare part for increasing the stressed area. It means that this light could be installed well without it.

(2) You don't need to use the extension bar of the bracket when install G5 on a tank narrower than 20.5inches.

Any problems encountered during installation, please do not hesitate to contact us!